

STEERING MOTOR $\phi 106$ WITH PLANETARY GEAR IMS PM 81LN
2 STAGE REDUCT. RATIO I = 1:45 (REV. 0 OF 25/05/2011)

POTENZA POWER 400 W	TENSIONE VOLTAGE 48 V	CORRENTE CURRENT 16 A	RPM 2750	SERVIZIO SERVICE S2 = 60'	SERVIZIO SERVICE S3 = 70 %	CLASSE ISOL. H	WITHOUT VENTILATION	ECCITAZIONE AC (3M) 100hz	PESO WEIGHT Kg 11,4
----------------------------------	------------------------------------	------------------------------------	--------------------	--	---	-----------------------------	-------------------------------	-------------------------------------	----------------------------------

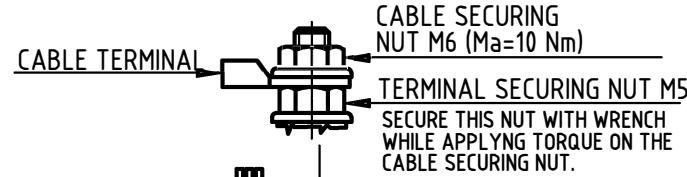

CONNECTOR TYPE:
 MOLEX 5557-06R
 PINS MOLEX 5556-TL
 MARKED X19

IP CLASS : IP 20

SLOTTED ROUND NUT FOR HOOK SPANNER GUK 4 (M20x1)
 TIGHTENING TORQUE: 45Nm

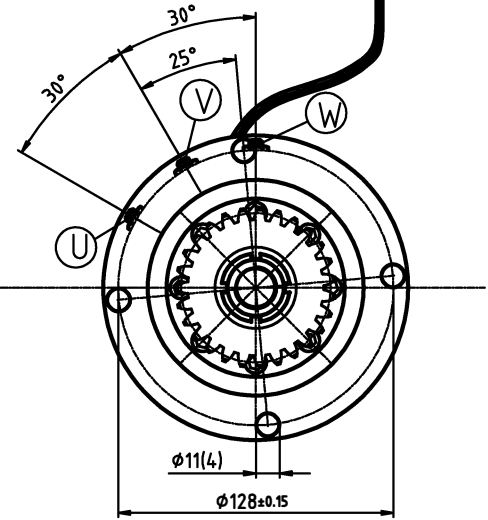
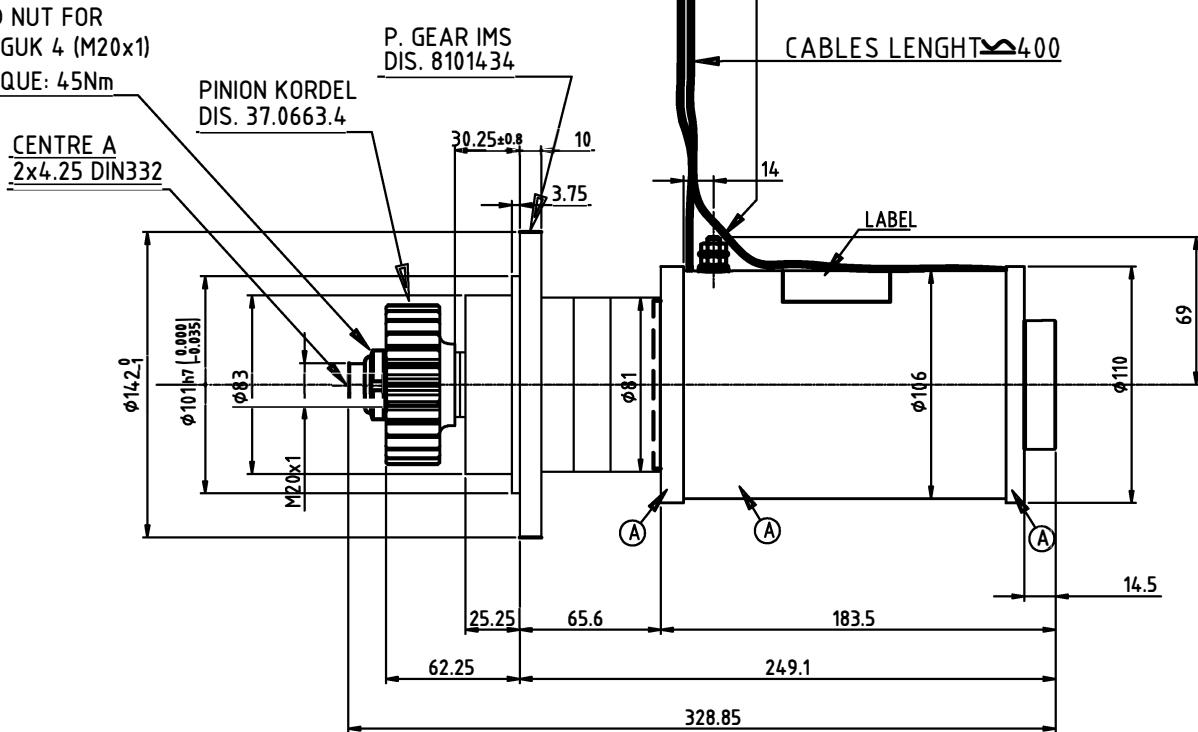

(A) = ZINC PLATED SURFACE

G104449D

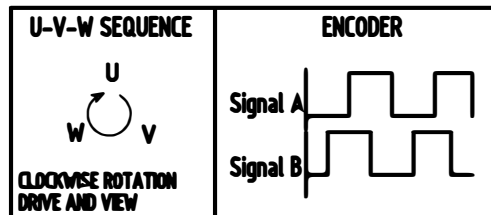

General tolerance : +/- 0,1mm

INCREMENTAL ENCODER		
N° PULSE REVOLUTION:		4
N° PIN:	DESCRIPTION:	COLOUR:
1	+VCC	YELLOW
2	GND	BROWN
3	SIGNAL A	WHITE
4	SIGNAL B	GREEN
5	SENSOR KTY 84-130	BLACK
6	SENSOR KTY 84-130	RED

Firma PROG. : PO M.