

**BEST MOTOR**Tel. 059 - 858059
fax. 059 - 850410**MOTORE-TRAZIONE AC4 POLI ϕ 150 IP 30 CON ENCODER
ESTERNO A 48 imp/giro (REV. 1 DEL 27/12/2012)**

POTENZA POWER 1000 W	TENSIONE VOLTAGE 24 V	CORRENTE CURRENT 60	RPM 2000	SERVIZIO SERVICE S2 = 60'	SERVIZIO SERVICE S3 = 70 %	CLASSE ISOL. H	VENTILAZIONE INTERNA	ECCITAZIONE AC (70Hz)	PESO WEIGHT Kg --
-----------------------------------	------------------------------------	----------------------------------	--------------------	--	---	-----------------------------	--------------------------------	---------------------------------	--------------------------------

SUPERSEAL-6vie(ENCODER)

SUPERSEAL-2vie(Sonda termica 160°)

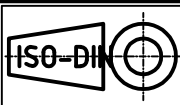
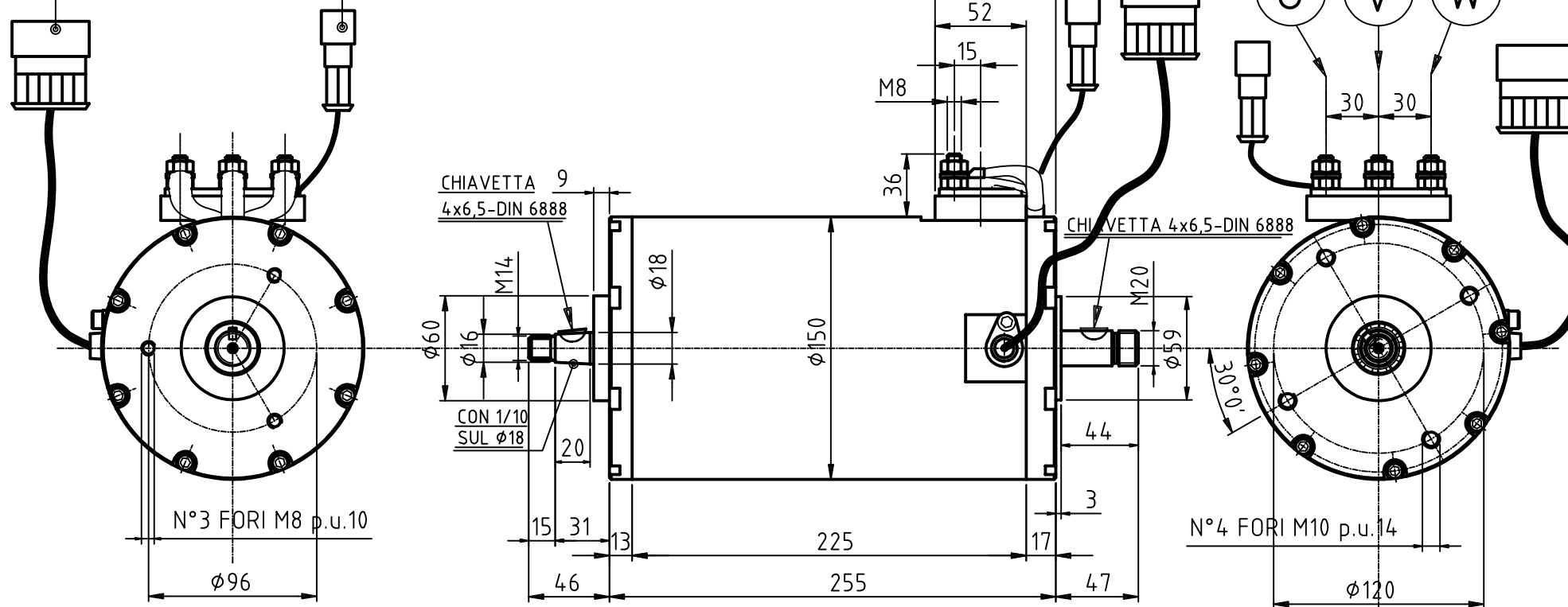

Cod.: G1101500

Firma PROG. : Po M.

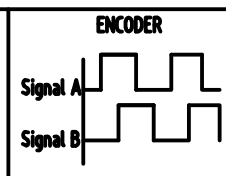
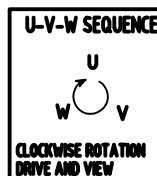

INCREMENTAL ENCODER		
OUTPUT FORM:	OPEN COLLECTOR	
POWER SUPPLY:	+5 / +24 VDC	
OUTPUT CURRENT	20 mA max.	
N° PULSE REVOLUTION:	48	
N°PIN:	DESCRIPTION:	COLOUR:
1	+VCC	RED
2	GND	BLACK
3	SIGNAL A	WHITE(Green)
4	SIGNAL B	BLUE
5/6	//	

G1101500